

Design of this pizza oven was based on wanting a more modern finish and also fitting in with the planned outdoor kitchen.

This structure could be built into a retaining wall so as it was flush (block work size would be increased and steel bars installed).

Or you could leave out the upper block work all together and render the oven dome for a more traditional feel.

MATERIALS LIST

Slabs/Blockwork

100 x 50 mm Formwork and pegs

F82 Mesh 3 @ 1820 x 1660 mm

Y12 Rebar 10 @ 1660

Concrete approx. 1.4 Cubic meter (over four pours)

Blocks 160 @ 140 x 190 x 390 mm (15.01 series)

Blocks 7 @ 190 x 190 x 390 mm (20.01 series)

Corrugated iron 5 @ 1800 mm (1760 mm)

Brickies sand + Cement

Refractory supplies

(s/s) Brick 80 @ 230 x 115 x 75 mm

(51) Brick 42 @ 230 x 115 x 75/51 mm

(63) Brick 102 @ 230 x 115 x 75/63 mm

Calsil Bricks @ 230 x 115 x 70 mm

Refractory tiles @ 300 x 300 x 50 mm

Ceramic fiber roll 2 @ 25 x 600 x 7200 mm

Vermiculite

High temperature mortar 7 @ 25 kg bags

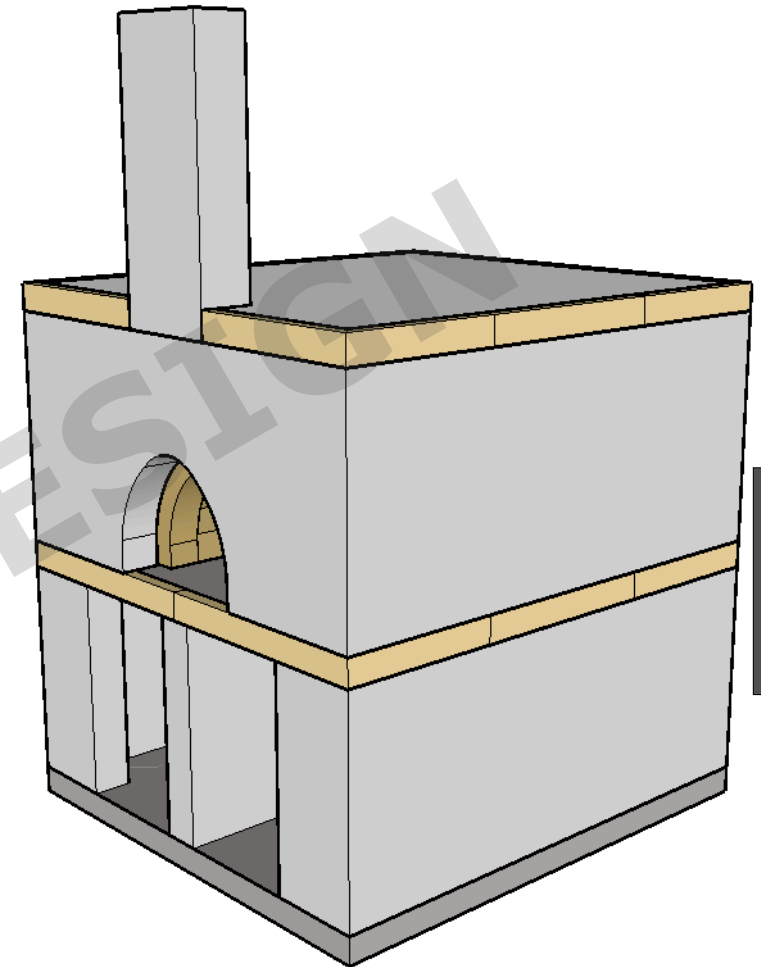

CHERUB

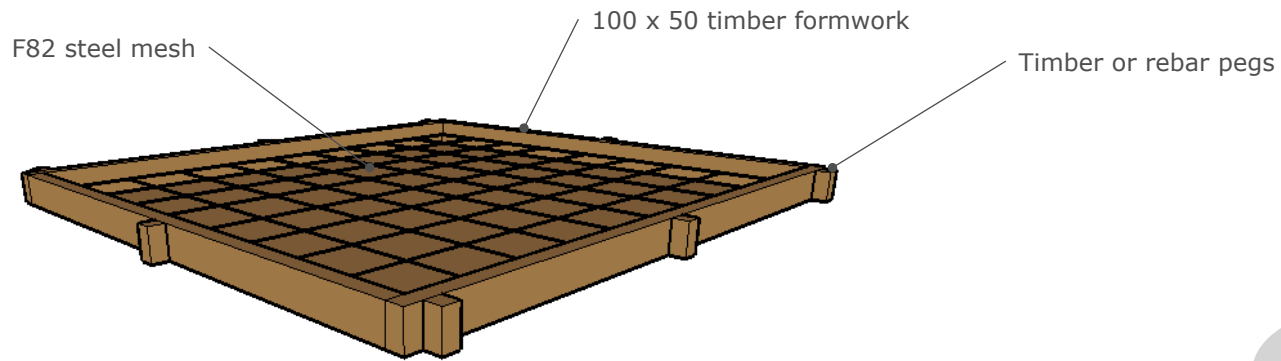

Strong footings are essential as structure will weigh considerable amount. If constructing to different dimensions you will alter size here

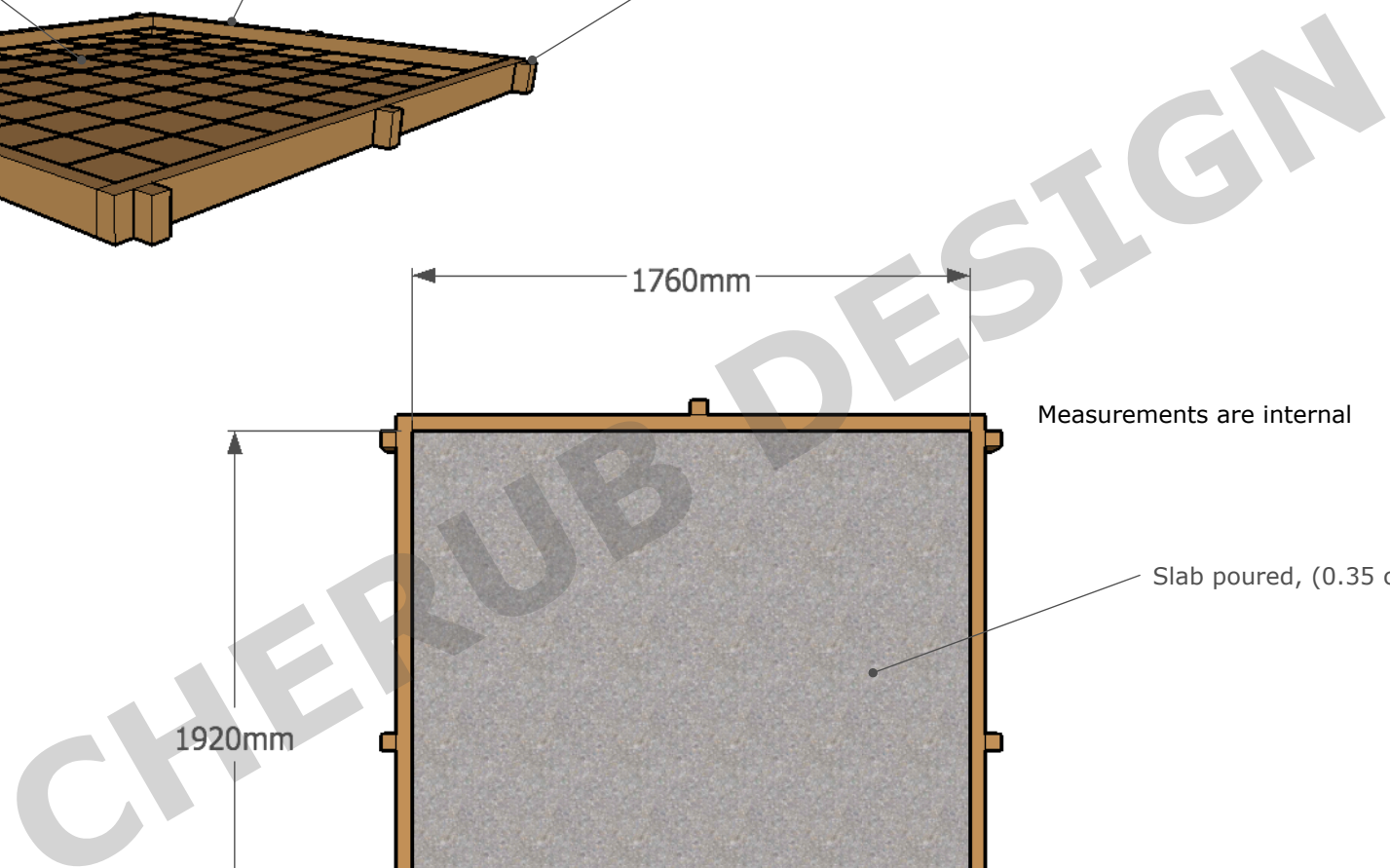

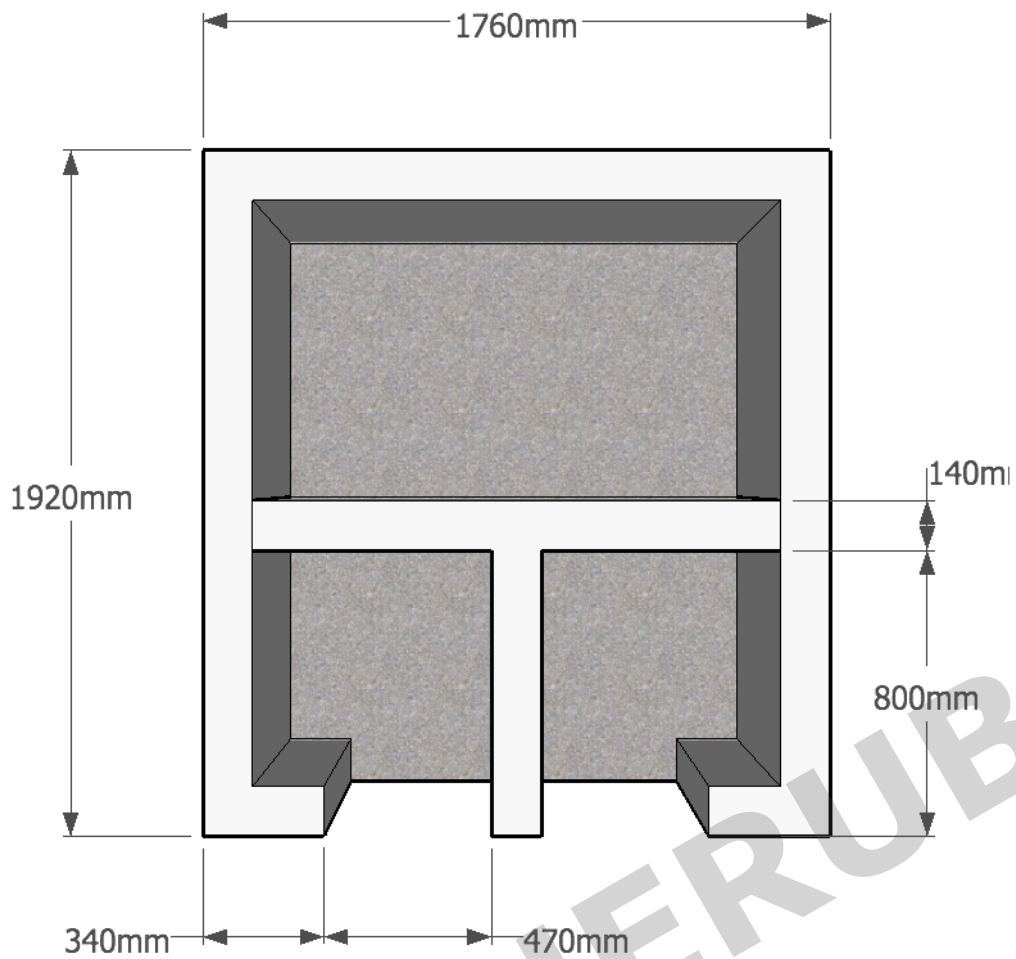

Used 140 mm blocks for speed and strength, If your not comfortable laying blocks then bricks would be fine, you will just have to adjust dimensions to suit.
Overall height of blockwork is 800 mm. (four courses)

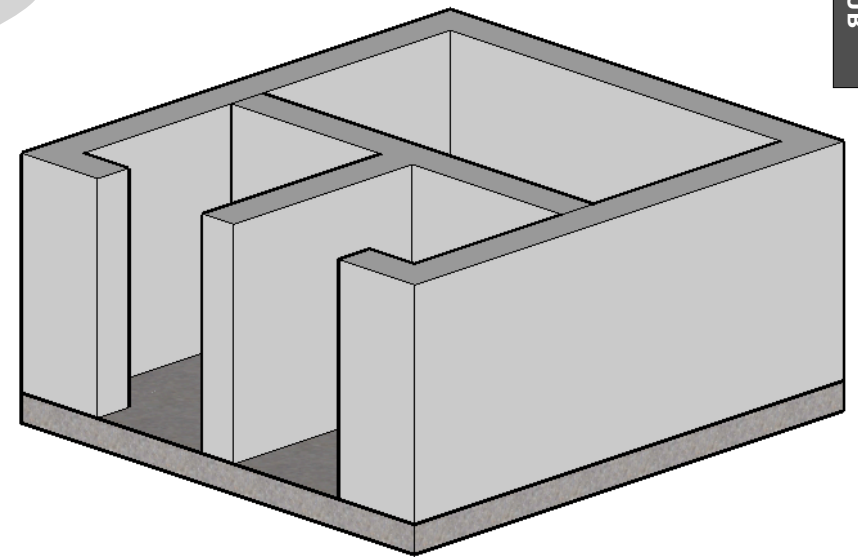

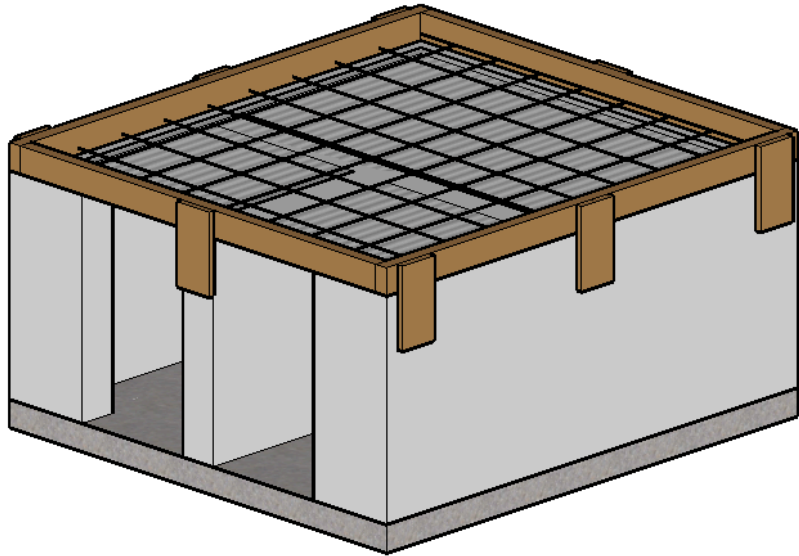

Once blockwork for the base is complete, form up for the mid slab. The method i used here enabled me to lay a sandstone border on the slab edge (this tied in with sandstone used elsewhere but you could use pavers tiles etc. will just have to adjust dimensions to suit) 100 x 50 mm formwork was reused from the base slab. Just fix off 300 x 100 x 19 mm ply as uprights, (use raw plugs and screws). Then attach formwork, Lay corrugated iron covering block work then steel. Here you can also add 12 mm rebar @ 300 centers to stiffen the slab up.

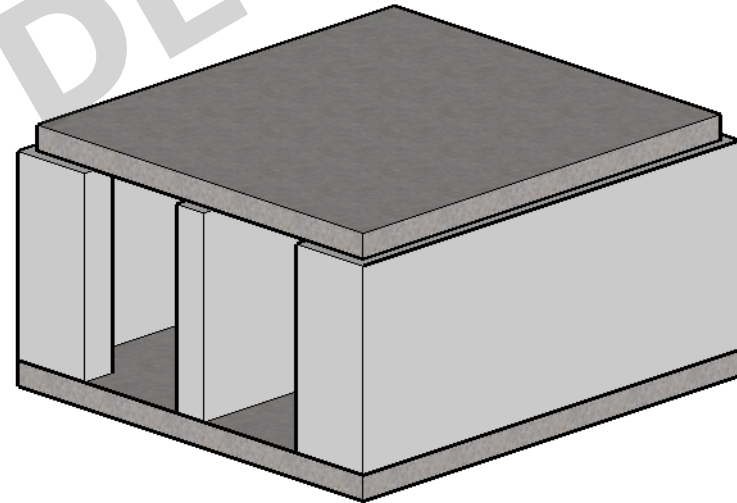

CHERUB DESIGN

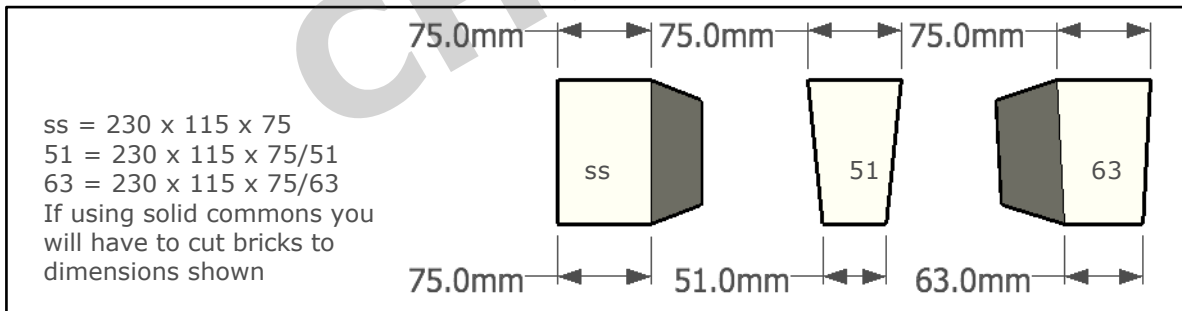
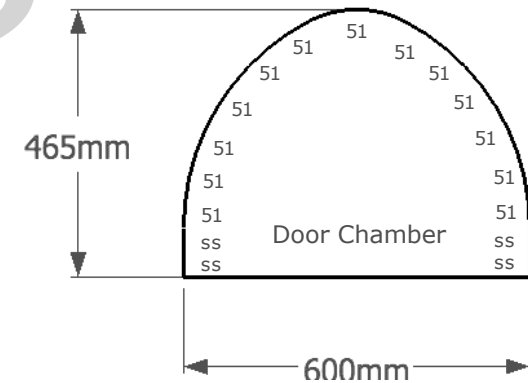
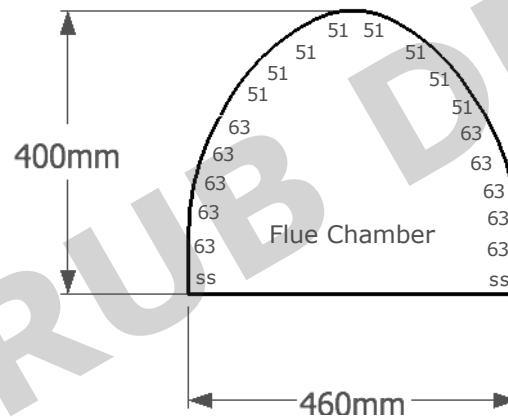
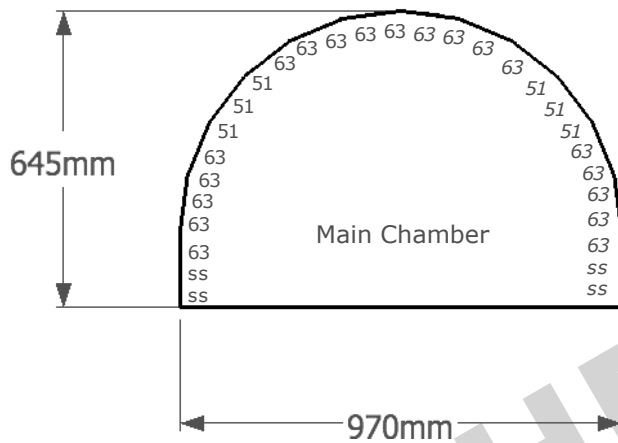
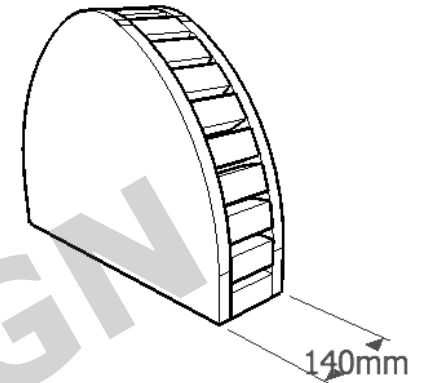
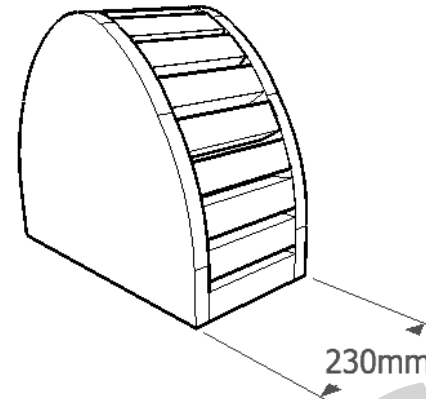
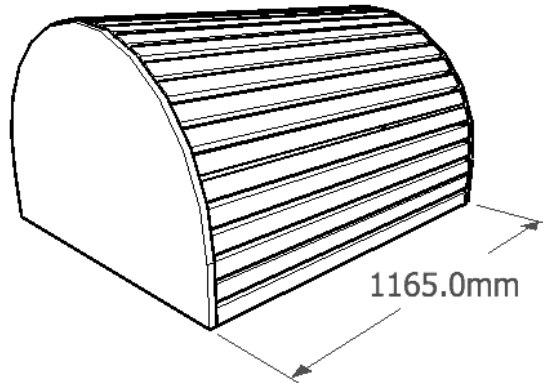

To make templates space out bricks as indicated on plywood with 3 mm gaps, arrange until shape is symmetrical. Once happy with shape mark outline plus bricks and joints on plywood (this helps in keeping courses aligned). Cut out plywood and construct formwork using slats. Screws should be used so to make removal easier.

Construction well under way, showing Base slab/Base blockwork/Sandstone perimeter and oven formwork in place.

Place oven formwork in situ and align to base, then remove flue and door arches leaving main chamber. (tip is to use 10 mm packer under all formwork so on completion of brickwork it will give a bit of play when removing) Start laying bricks as per plan. Leave overnight.

Remove main chamber formwork by unscrewing plywood from both ends, then removing slats. Lay calsil bricks in main chamber, these are laid loose on base in a brick bond pattern. Then lay 300 x 300 base tiles over calsil bricks cutting were necessary. Lay brickwork to rear end of chamber.

Place door arch formwork in place, lay bricks. Infill gap between main chamber and door arch.

Remove door arch chamber formwork by unscrewing plywood from both ends, then removing slats.

Place flue arch formwork in place.

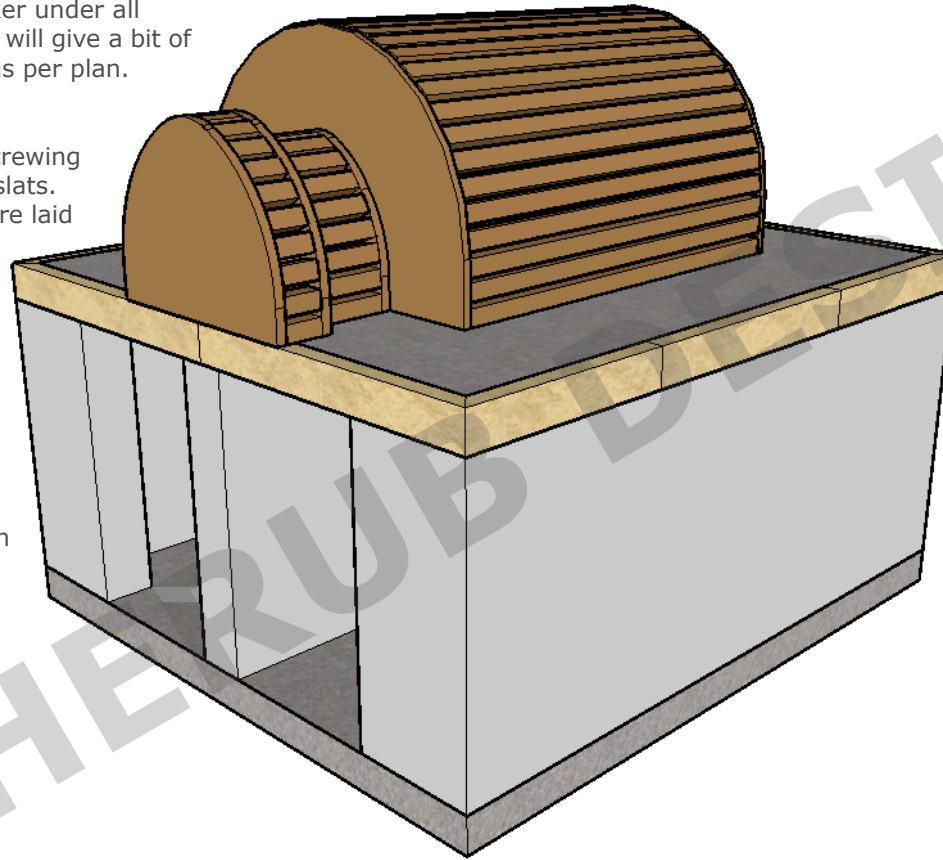

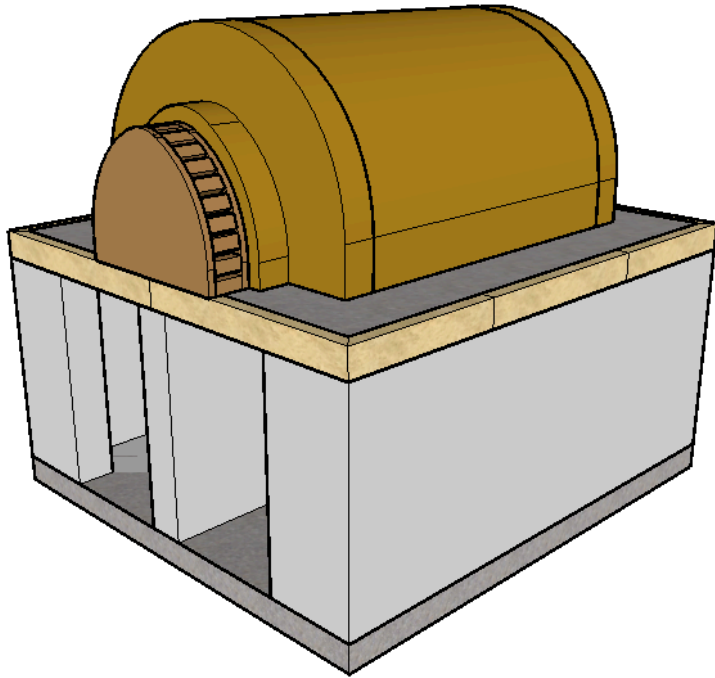

Lay blockwork to perimeter of mid slab with flue arch formwork in place. Make sure flue blocks are centered with flue arch. Cores in blocks are used for flue (will have to cut blocks to suit). Or if preferred you can use a stainless steel flue in place of blocks. After blockwork complete lay two layers of ceramic blanket overlapping joints, (wear gloves and face mask). Then fill void with vermiculite. At this stage fill block work with concrete, except void were flue is situated (stuff with newspaper)

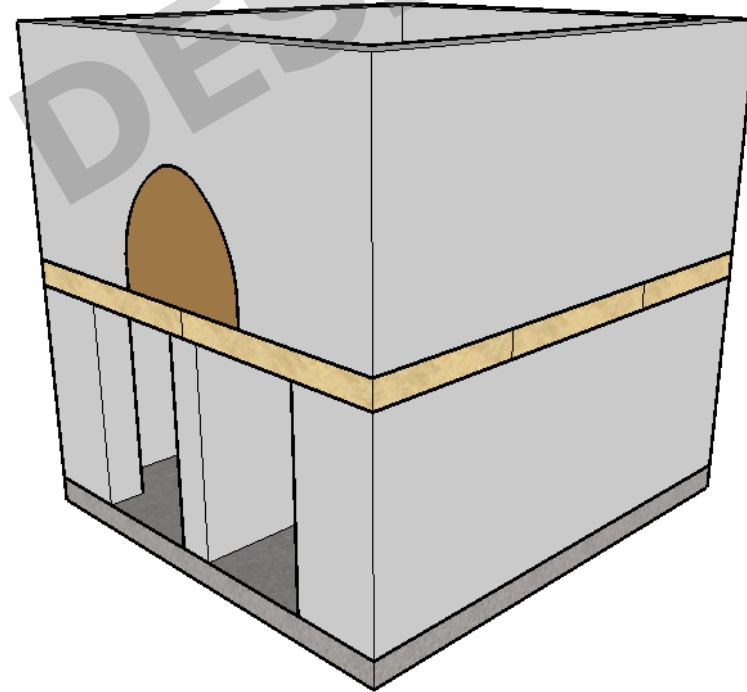

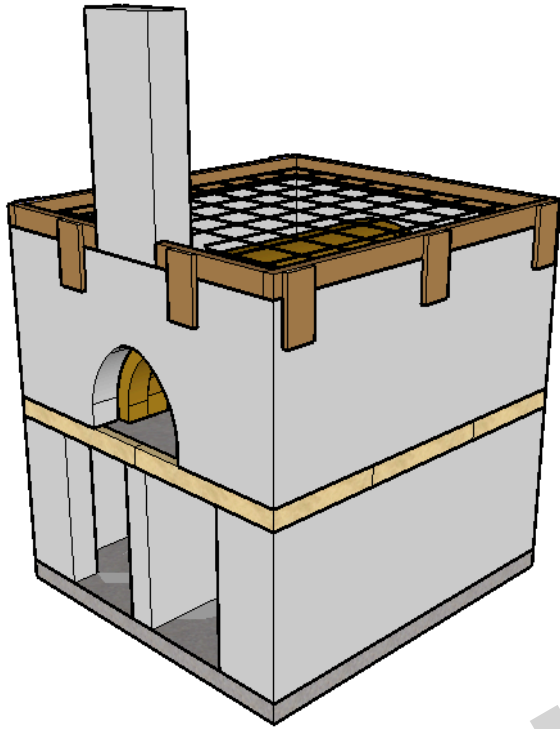

If using block work for flue lay rest of blocks.
Form up upper slab using same method as before.
Lay plastic over vermiculite, cut mesh to suit, once
again add rebar to mesh. Concrete top slab, leave
24 hrs remove formwork.
Glue sandstone in place (tile adhesive).
Render or bag to finish.

